

Artcoustic^{AI}

CPH-200S SUBWOOFER

Owners manual



WELCOME TO THE WORLD OF ARTCOUSTIC

Congratulations with your purchase of the Artcoustic CPH-200S Active Subwoofer.

The CPH-200S is an efficient active double-tuned band pass design, producing a fast, dynamic bass response and exceptional musical authority, easily integrated into any small to medium Artcoustic system.

The CPH-200S active Subwoofer is a low resonance frequency 4th. order band pass design, which ensures powerful and clean bass, within a remarkably small in-room installation space.

The CPH-200S active Subwoofer features a single high-quality 10 inch bass unit, fitted within a specially tuned, elegant and contemporary cabinet, offering discrete floor or cabinet placement.

This new design technology allows superb output performance to be possible in a cabinet much smaller than would otherwise be required.

The CPH-200S is powered by a state-of-the-art powerful 200 Watt RMS digital amplifier, all controlled by easy to use volume, phase and active crossover functions.

Nearly 20 years of subwoofer technology and acoustic evolution, has merged into the most advanced and powerful subwoofer series ever produced by Artcoustic.

Thank you for purchasing an Artcoustic product.

All the best,
The Artcoustic Team

FEATURES

CPH-200S SUBWOOFER

CPH-200S subwoofer delivers amazing bass, ideal for home cinemas, 2.1 channel multi-room, Hi-Fi applications and fixed installations in general.

Employing one 10" woofer, capable of reproducing low frequency signals accurately, the CPH-200S subwoofer is ideal for use in high-end installations where sound quality is paramount.

For larger rooms, or where a higher SPL is required, use multiple units.

INPUT SENSITIVITY CONTROL

SWITCH PHASE CONTROL

0 or 180 degrees

AUTO TURN ON, TURN OFF
SIGNAL SENSING

VARIABLE CROSSOVER, LOW-PASS
40Hz. - 120Hz. 24 dB/octave

EXTENDED PROTECTION CIRCUIT

S/N RATIO
>103 dB

THD (at 1 watt into 8 ohms 1KHz)
<0.05%

INPUT IMPEDANCE
20 K Ω balanced

MAXIMUM INPUT LEVEL
7V

LOAD IMPEDANCE
4-8 Ω

INPUT SENSITIVITY
0 dB

POWER SUPPLY
115 V/230 V-50/60 Hz

INPUT TERMINAL
RCA

PROTECTION
Heat, over current, Short and DC

WOOFER

Extra long excursion and aluminium Short Circuit Ring, 4-layer 50mm voice coil, anodized aluminium for improved heat dissipation, combined with Distortion Reduced Motor and vented pole piece for optimized linear excursion

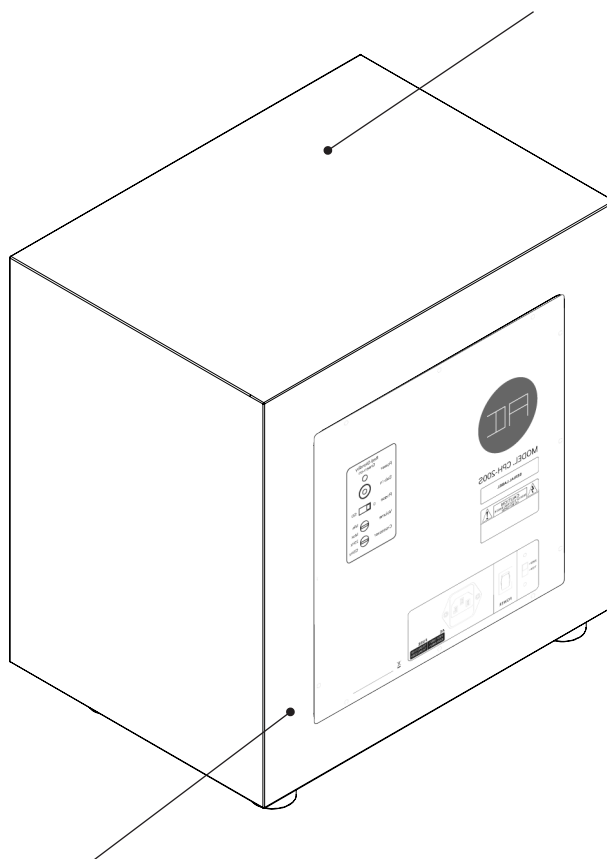

DESIGN

Artcoustic Low resonance frequency
4th order band pass design
Slimline, minimal cabinet design
High-quality Danish components

SPECIFICATIONS

CPH-200S SUBWOOFER

POWER CHARACTERISTIC

THD (at 1 watt into 8 ohms 1KHz):<0.05%
Input Impedance: 20 Kohms balanced
Maximum input level: 7V
Load impedance: 4-8 ohms
Input sensitivity: (0dB)
Power supply: 115V/230V - 50/60Hz
Input terminal: RCA

TRANSDUCER

LF-MF 1 x 10 inch cone

PERFORMANCE

Operating Range: 30 Hz to 120 Hz
Nominal Beam Width: Omni Directional
Maximum Power: 200 Watt 8 ohms RMS Class D
Calculated Axial Output Limit (Half Space SPL) Average Peak LF:

30 Hz	40 Hz	50 Hz
109 dB	112 dB	118 dB

DESIGN

Cabinet: Black, White, RAL, NCS, Tikkurila, Gloss
Weight: 15 kg
Dimensions: H: 400 W: 400 D: 290 mm

OPERATING RANGE

30 Hz — 120 Hz

MAX SPL



109 dB
30 Hz

NOMINAL BEAM WIDTH



Omni Directional

MAXIMUM POWER

■■■■■■■■■■
200 Watt
Impedance
8 ohms RMS

LOAD IMPEDANCE



4-8 ohms

DIMENSIONS



H: 400 W: 400 D: 290 mm

WEIGHT



15 kg



OVERVIEW

CPH-200S SUBWOOFER

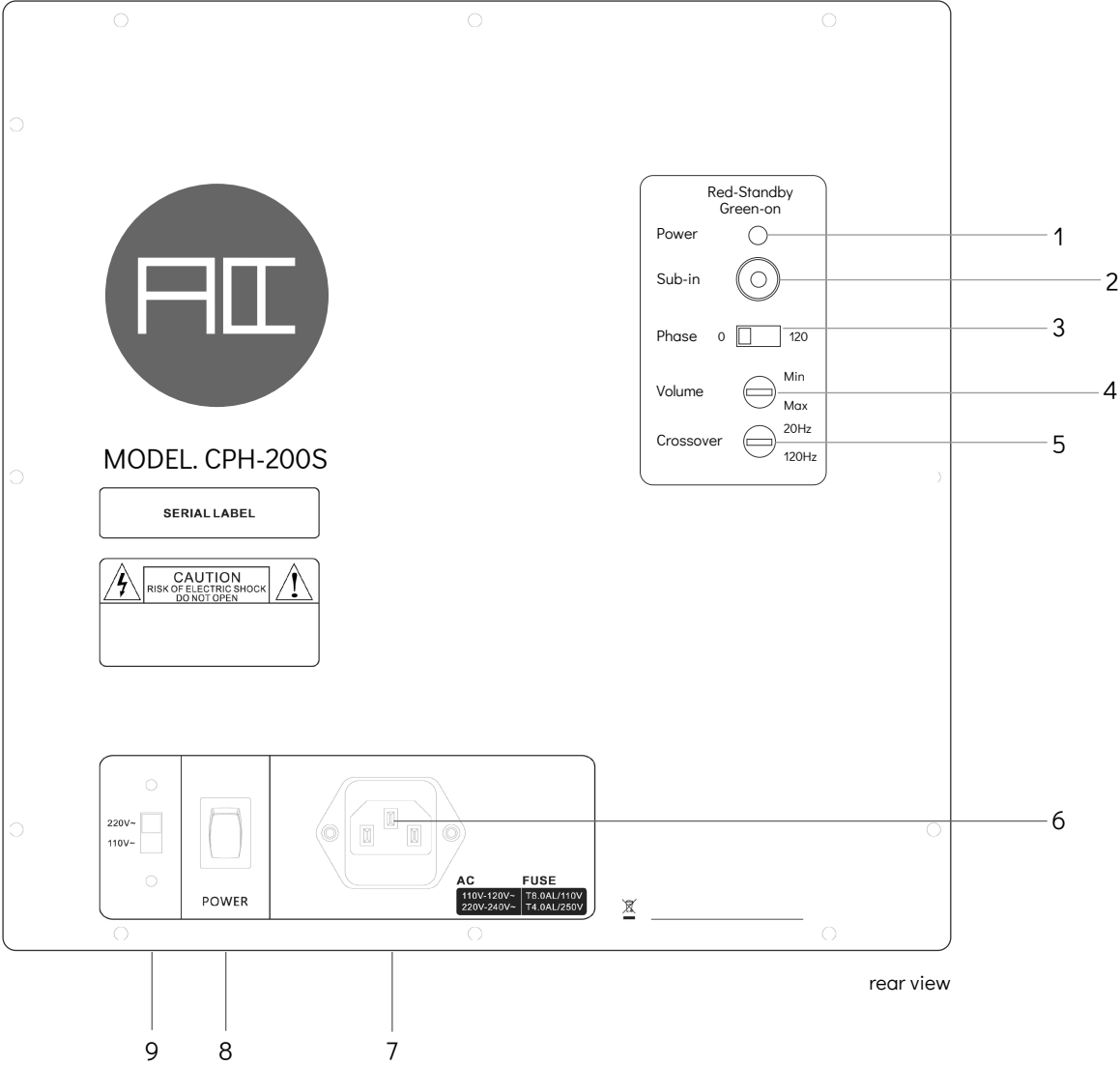

- 1. Power LED
- 2. RCA Input
- 3. Phase Switch
- 4. Input Sensitivity
- 5. Low Pass Crossover
- 6. AC Power Socket
- 7. Fuse
- 8. ON/OFF Switch
- 9. Power Selector



SCHEMATICS

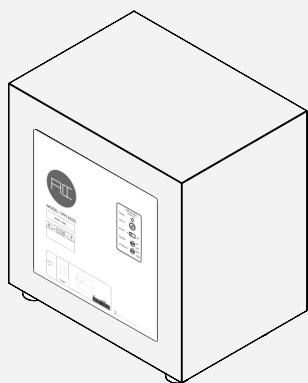

isometric view

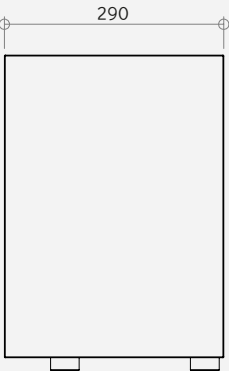
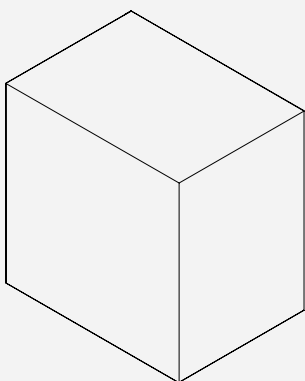

side view

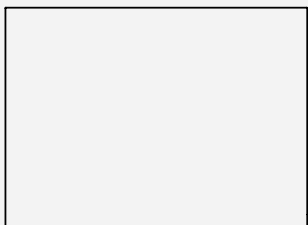

top view

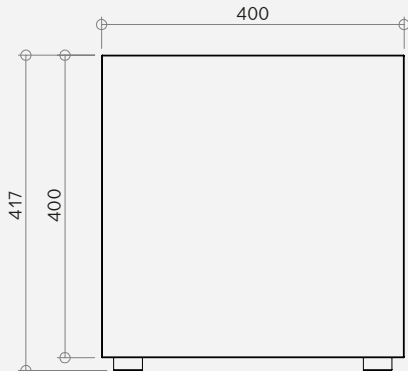

front view

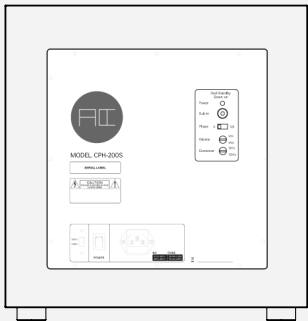

rear view

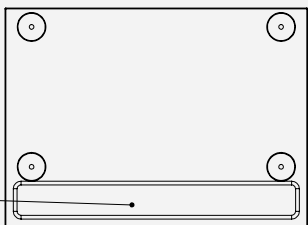

bottom view

IMPORTANT ! port, do not cover



CONNECTIVITY

CONNECTING ARTCOUSTIC X10 RF WIRELESS SYSTEM

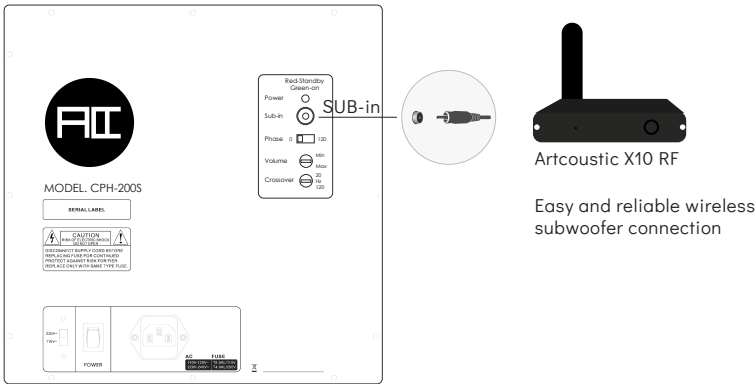

CONNECTING ARTCOUSTIC CPH-TRIO

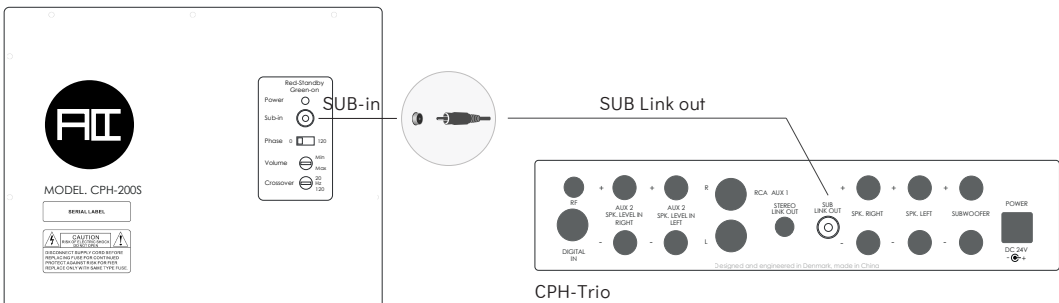

CONNECTING ARTCOUSTIC CPH-ATiB

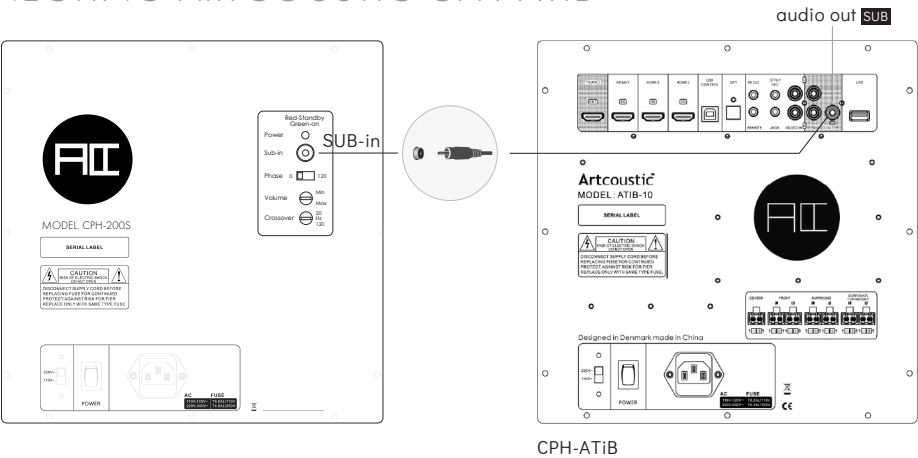

SAFETY INSTRUCTIONS

SAFETY



Do not use this product near water



Clean rear panel with dry cloth only



Do not block any ventilation opening



Do not install near any heat sources



If wall-mounted, ensure the use of matching screws and rawl plugs

Refer all servicing to qualified service personnel. Servicing is required when the product has been damaged in any way, such as power-supply cord or plug is damaged, liquid has been spilled or objects have fallen into the product, the product has been exposed to rain or moisture, does not operate normally or has been dropped.

To completely disconnect unit power from the AC mains, disconnect the unit's power cord from the mains socket.

Note: If the Artcoustic subwoofer is placed on a thick carpet blocking the air outlet, we recommend to use the special Artcoustic carpet spikes. Not included as standard, please order separately.

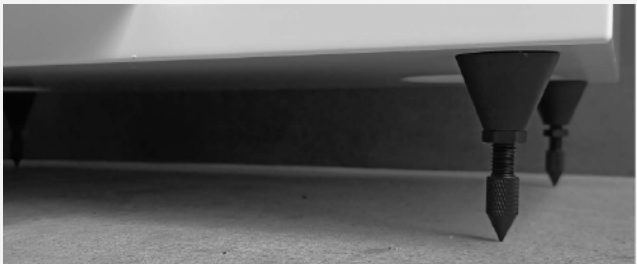

WARNING

This product complies with Part 15 of the FCC Rules. Its operation is subject to the following two conditions:

- This product may not cause harmful interference.
- This product must accept any interference received, including interference that may cause undesired operation.

Changes or modifications not expressly approved by the party responsible for compliance could void the user's authority to operate the equipment.

To reduce the risk of fire and electric shock do not expose this product to rain or moisture.



Do not place product filled with liquids such as vases on the product.



Do not open product. There are no user-serviceable parts inside.



Always use the power supply shipped with this product. Using a power supply with wrong voltage or polarity, can damage the electronics.



WARRANTY

IS APPLICABLE



Is valid only for products purchased from an authorised Artcoustic retailer or dealer.



Is valid from the date of purchase for a period of 3-years for passive loudspeakers, and 2-years for powered loudspeakers and electronics.



Is limited to the repair of the equipment (which could be a repair or replacement at our discretion, neither of which affects your original warranty).



Neither transportation, nor any other costs, nor any risk for removal, transportation and installation of products is covered by this warranty.

IS NOT APPLICABLE

Will not be applicable in cases other than defects in materials and/or workmanship at the time of purchase and will not be applicable:

- For deterioration of component parts, the nature of which is to become worn or depleted with use, such as batteries.
- For damages caused by incorrect installation, connection or packing.
- For damages caused by accidents, lightning, water, fire heat, war, public disturbances or any other cause beyond the reasonable control of Artcoustic and its appointed distributors.
- For damages caused by any use other than correct use described in the user manual, negligence, modifications, or use of parts that are not made or authorized by Artcoustic

If it is found necessary to return the product for repair, you will be given a form to fill out and return. You should not return the product without previous acceptance. To validate your warranty, you will need to produce the original sales invoice or other proof of ownership and date of purchase.